

Dimensions mm[inch]



tolerances acc. to DIN ISO 2768-m
Toleranzen gem. DIN ISO 2768-m

Isometric

Scale 1:5
Maßstab 1:5

Terminals

ends tinned
Enden verzinkt

Cable

LIYY 2x0,14 mm², grey
colour of wires: white and brown
LIYY 2x0,14 mm², grau
Aderfarben: weiss und braun

Nut

polypropylene, white
Mutter, Polypropylen, weiss

O-ring

nitrile caoutchouc black
O-ring Nitril Kautschuk schwarz

Stem

polypropylene white
Schaft Polypropylen weiss

Washer

polypropylene white
Sicherungsscheibe
Polypropylen weiss

Marking of magnet

position in the float
Markierung der Magnetposition
im Schwimmer

Float MS02

polypropylene white
Schwimmer MS02 Polypropylen weiss

Stopper

polypropylene white
Stopper Polypropylen weiss

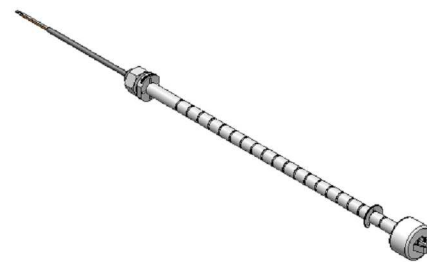

Switching scale

Schematic



CLOSED
GESCHLOSSEN



OPEN
GEÖFFNET

Marking

according to EN60062/factory code
gem. EN60062/Fertigungsstätte

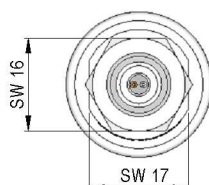
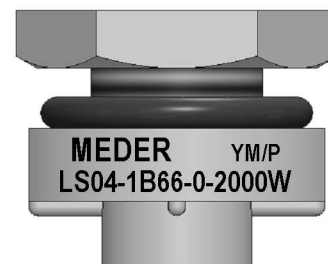



Europe: +49 / 7731 8399 0

| Email: info@standexmeder.com

Item No.:

USA: +1 / 508 295 0771

| Email: salesusa@standexmeder.com

9542660204

Asia: +852 / 2955 1682

| Email: salesasia@standexmeder.com

Item:

LS04-1B66-0-2000W

Special Product Data	Conditions	Min	Typ	Max	Unit
Contact rating	Any DC combination of V & A not to exceed their individual max.'s			10	W
Switching voltage	DC or Peak AC			180	V
Carry current	DC or Peak AC			1,25	A
Switching current	DC or Peak AC			0,5	A
Sensor-resistance	measured with 40% overdrive			700	mOhm
Housing material		PP			
Case colour		nature			
Sealing compound		Polyurethan			

Environmental data	Conditions	Min	Typ	Max	Unit
Operating temperature	cable not moved	-30		80	°C
Operating temperature	cable moved	-5		80	°C
Storage temperature		-30		80	°C
Safety class	DIN EN 60529	IP68			

Cable specification	Conditions	Min	Typ	Max	Unit
Cable type		round cable			
Cable material		PVC			
Cross section		0,14 sq-mm			

General data	Conditions	Min	Typ	Max	Unit
Mounting advice		over 5m cable, a series resistor is recommended.			
Tightening torque				1	Nm

Modifications in the sense of technical progress are reserved

Designed at: 30.01.14 Designed by: WKOVACS

Approval at: 30.01.14 Approval by: DKUECHLER

Last Change at: 25.07.14 Last Change by: GPAPPALARDO

Approval at: 25.07.14 Approval by: GPAPPALARDO

Version: 04