

**Dimensions mm[inch]**  
tolerances according to DIN ISO 2768-m  
Toleranzen gem. DIN ISO 2768-m

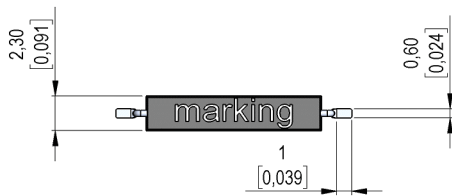

**Isometric**  
Scale 2:1  
Maßstab 2:1

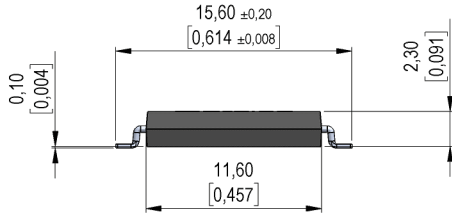

**Recommended PCB Pad Layout**

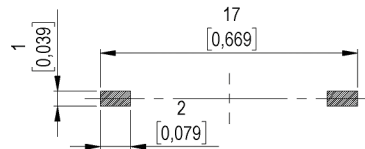

**Solder Reflow Profile**

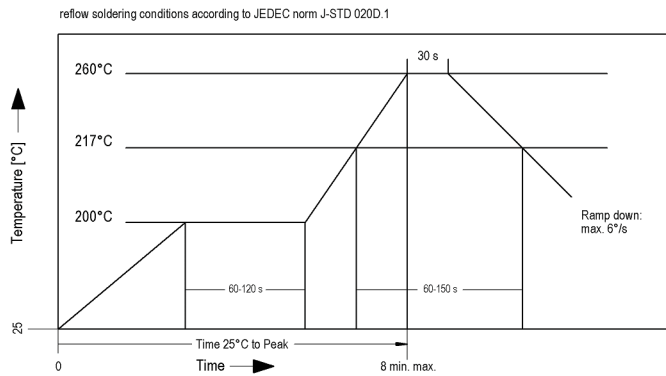

**Packaging**

**Bulk**



Europe: +49 / 7731 8399 0

| Email: info@standexmeder.com

Item No.:

USA: +1 / 508 295 0771

| Email: salesusa@standexmeder.com

**9161879024**

Asia: +852 / 2955 1682

| Email: salesasia@standexmeder.com

Item:

**MK16-D-2-Bulk**

| Magnetic properties                   | Conditions                                  | Min    | Typ | Max | Unit |
|---------------------------------------|---|--------|-----|-----|------|
| Test-Coil                             | Reed switch unmodified                      | KMS-01 |     |     |      |
| Pull-In                               | at 20°C                                     | 40     |     | 64  | AT   |
| Test equipment                        |   | KMS-11 |     |     |      |
| Pull-In in milliTesla (modified conta | MS150 -<br>phys. caused tolerance +/- 0,1mT | 2      |     | 3,1 | mT   |
| Test equipment                        |   | MS-150 |     |     |      |

| Contact data 87           | Conditions   | Min     | Typ | Max | Unit |
|---------------------------|--|---------|-----|-----|------|
| Contact-material          | Plating thicknesses are proprietary                                  | Rhodium |     |     |      |
| Contact rating            | Any DC combination of V & A<br>not to exceed their individual max.'s |         |     | 10  | W    |
| Switching voltage         | DC or Peak AC  |         |     | 200 | V    |
| Carry current             | DC or Peak AC  |         |     | 0,5 | A    |
| Switching current         | DC or Peak AC  |         |     | 0,4 | A    |
| Contact resistance static | Measured with 40% overdrive<br>Start Value                           |         |     | 150 | mOhm |
| Breakdown voltage         | according to EN 60255-5  | 230     |     |     | VDC  |

| Special Product Data | Conditions | Min                 | Typ | Max | Unit |
|----------------------|------------|---------------------|-----|-----|------|
| Housing material     |            | epoxy resin         |     |     |      |
| Approval             |            | UL-File Nr. E156887 |     |     |      |

| Environmental data          | Conditions                         | Min          | Typ | Max | Unit |
|-----------------------------|------------------------------------|--------------|-----|-----|------|
| Shock                       | 1/2 sine, duration 11ms, in 3 axis |              |     | 30  | g    |
| Vibration                   | from 10 - 2000 Hz                  |              |     | 20  | g    |
| Ambient temperature         |                                    | -40          |     | 130 | °C   |
| Storage temperature         |                                    | -50          |     | 130 | °C   |
| Soldering Temperature Tsold | Reflow acc.IPC/JEDEC J-STD-020D.1  |              |     | 260 | °C   |
| Cleaning                    |                                    | fully sealed |     |     |      |

| General data      | Conditions         | Min          | Typ | Max | Unit |
|-------------------|--------------------|--------------|-----|-----|------|
| Component marking | general descripton | MEDER D YM/P |     |     |      |

Modifications in the sense of technical progress are reserved

Designed at: 06.06.17 Designed by: THAUKE

Approval at: 12.06.17 Approval by: MREIZNER

Last Change at: Last Change by:

Approval at: Approval by:

Rev. No.: 1