



*Products for tomorrow*

Headquarter Europe  
 MEDER electronic AG  
 Friedrich-List Strasse 6  
 D-78234 Engen-Welschingen  
 Tel.: +49(0)7733-9487-0  
 Fax: +49(0)7733-9487-32  
 eMail: [info@meder.com](mailto:info@meder.com)  
 Internet: [www.meder.com](http://www.meder.com)

Headquarter USA  
 MEDER electronic Inc.  
 766 Falmouth Rd  
 Mashpee, MA 02649  
 Phone: +1/ 508-539-0002  
 Fax: +1/ 508-539-4088  
 eMail: [salesusa@meder.com](mailto:salesusa@meder.com)

Reed Relay: BE24-1A31-10P

Part Number: 8824131010

Dimensions (mm) unspecified tolerances +/- 0.1mm

Layout / Pitch 2.54 mm / Top View

Marking

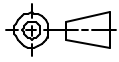
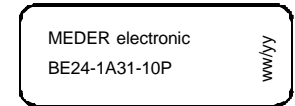
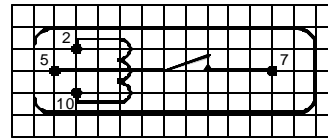
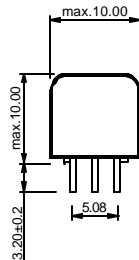
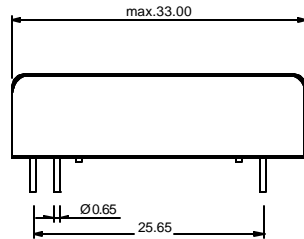

Pins: Ø 0,65 mm / L 3.2 ± 0,2 mm

Coil/Relay Characteristics	Conditions at 20°C	Min.	Typ.	Max.	Units
Coil Resistance		2700	3000	3300	Ω
Nominal Voltage			24		VDC
Nominal Rated Power			190		mW
Operate Voltage				16.8	VDC
Release Voltage		3.6			VDC

Contact Data 31 (Form A/wetted)				
Contact Rating	Any combination of the switching voltage and current must not exceed the given rated power		50	W
Switching Voltage	DC or Peak AC		1000	V
Switching Current	DC or Peak AC		2.0	A
Carry Current	DC or Peak AC		3.0	A
Static Contact Resistance (initial)	Measured with Nominal Voltage		80	mΩ
Insulation Resistance	RH 45%	10 <sup>10</sup>		Ω
Breakdown Voltage		1.5		kVDC
Operate Time, including Bounce	Measured with Nominal Voltage		1.2	ms
Release Time	Measured with no coil suppression		1.0	ms
Capacitance			0.3	pF

Environmental Data				
Insulation Resistance Coil to Contact	RH 45%	10 <sup>12</sup>		Ω
Dielectric Strength Coil to Contact		2.0		kV DC
Shock	½ sine wave, duration 11ms		50	g
Vibration	from 10 - 2000 Hz		20	g
Operating Temperature	10°C/min max. allowable	-20	70	°C
Storage Temperature	10°C/min max. allowable	-40	105	°C
Soldering Temperature	5 sec. at		260	°C
Cleaning			fully sealed	
Material of Case			Metal	
Sealing Compound			Polyurethane	
Material of Pins			Cu-alloy tinned	
Remarks				

Customer / Customer part number	Standard Product
---------------------------------	------------------