

## ORT551-1 REED SWITCH

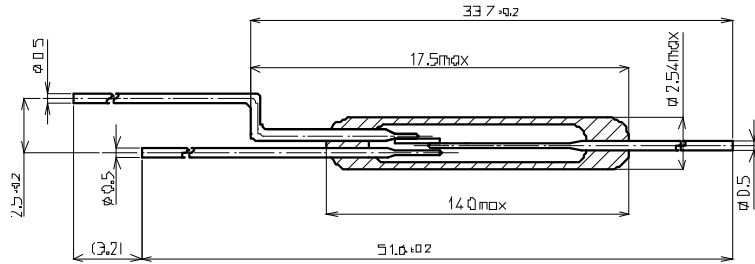

### . SPECIFICATIONS

#### 1-1. Electrical characteristics

1. Pull-in	---	AT	
		(in the 10AT to 30AT range)	
2. Drop-out	4	AT	min
3. Contact resistance	100	m	max
4. Breakdown voltage	150	DCV	min
5. Insulation resistance	10 <sup>9</sup>		min
6. Electrostatic capacitance	1.5	pF	max
7. Contact rating	3	W, VA	
8. Maximum switching voltage	DC30	V	
9. Maximum switching current	0.2	A	
10. Maximum carry current	0.5	A	

#### 1-2. Operating characteristics

1. Operate time	1.0	ms	max
2. Bounce time	1.0	ms(NO)	max
	1.5	ms(NC)	max
3. Release time	0.5	ms	max
4. Resonant frequency	6000 ± 4000	Hz	
5. Maximum operating frequency	200	Hz	

#### 1-3. Environmental characteristics

1. Shock	294	m/s <sup>2</sup>	(11ms)
2. Vibration	196	m/s <sup>2</sup>	(10 ~ 50Hz)
3. Temperature range	-40 ~ +125		
4. Lead tensile strength	19.6	N	

### . STRUCTURE AND DIMENSIONS

1. Contact arrangement	Form C		
2. Contact material	Rhodium		
3. Glass diameter	2.54	mm	max
4. Glass length	14.0	mm	max
5. Overall length	see figure		

DATE	REMARKS ON REVSES	DESIGNED	<b>OKI SENSOR DEVICE CORPORATION</b>	
		DRAWN	NOMENCLATURE	
		CHECKED	<b>ORT551-1 REED SWITCH</b>	
		APPROVED	REFERENCE	DRAWING NO.
		DATE OF ISSUE		